

DEMARCATON	SUPPORT MEMBER	BEARING LENGTH
BL21	L3/8x3/8x3/8	0'-4"
BL22	L4x3/8x3/8 LLV	0'-4"

BRICK LINTEL/BEARING SCHEDULE
SCALE: NOT TO SCALE

DEMARCATON	SUPPORT MEMBER	MINIMUM MOMENT CAPACITY	MINIMUM SHEAR CAPACITY	MINIMUM 'EI' x 1,000,000
FB21A	(3) 1 1/2"x16" LVL's	9,800 FT*POUNDS	1,270 POUNDS	300.040
FB21B	(3) 1 1/2"x9 1/2" LVL's	11,060 FT*POUNDS	3,640 POUNDS	675.180
FB22	(2) 1 1/2"x9 1/2" LVL's + 1/2"x9 1/2" STEEL PLATE	16,425 FT*POUNDS	18,675 POUNDS	2,584.440
FB23A	(3) 1 1/2"x16" LVL's	10,855 FT*POUNDS	2,170 POUNDS	675.180
FB23B	(2) 1 1/2"x9 1/2" LVL's + 1/2"x9 1/2" STEEL PLATE	31,210 FT*POUNDS	6,245 POUNDS	3,225.540
FB24	(3) 1 1/2"x14" LVL's	20,470 FT*POUNDS	4,305 POUNDS	2,160.870
FB25	(3) 1 1/2"x14" LVL's	30,210 FT*POUNDS	4,240 POUNDS	2,160.870

FLOOR BEAM SCHEDULE
SCALE: NOT TO SCALE

FLOOR BEAM SCHEDULE NOTES:

- FLOOR BEAMS HAVE BEEN SPECIFIED TO PROVIDE ALTERNATES FOR WOOD TRUSSES AND TO CLEARLY DEFINE THE FLOOR TRUSSES FOR THE WOOD TRUSS MANUFACTURER.
- IT IS ASSUMED THAT THE WOOD TRUSS MANUFACTURER WILL PROVIDE AN ENTIRE FLOOR SYSTEM USING WOOD TRUSSES. THE TABLE HAS BEEN PREPARED TO ASSURE THAT A FLOOR SYSTEM IS ATTAINABLE FOR THE DEPTHS AND CONFIGURATIONS REQUIRED ARCHITECTURALLY AND TO VERIFY THAT THERE IS A 'STRUCTURAL SOLUTION' SHOULD IT BE DETERMINED THAT WOOD TRUSSES ARE NOT ATTAINABLE TO SUPPORT THE CODE REQUIRED DESIGN LIVE LOADS AND DESIGN DEAD LOADS REQUIRED BY THESE CONTRACT DOCUMENTS.
- SHOULD THE ALTERNATE FLOOR BEAMS BE USED IN LIEU OF FLOOR TRUSSES, THE CONTRACTOR MUST PROVIDE THE ADDITIONAL FRAMING TO CREATE THE CEILING FOR THE FLOOR BELOW AND THE DESIGN OF THE WOOD TRUSS DESIGNS ALTERED TO ACCEPT ANY ADDITIONAL LOADS REQUIRED TO CREATE THE CEILING.
- FLOOR BEAMS FB21, FB22, AND FB23 HAVE BEEN SPECIFIED TO PROVIDE A CONSISTENT BEARING DEPTH. TRUSSES FRAMING INTO FLOOR BEAMS FB22 SHALL BE ATTACHED USING A SIMPSON STRONG TIE HANGER. THE TRUSS MANUFACTURER SHALL PROVIDE BOTTOM BEARING TRUSSES AT THE UNIFORM BOTTOM OF WOOD TRUSS ELEVATION.
- FLOOR BEAMS FB21A AND FB23A SHALL BE CENTERED BELOW THE CENTER OF THE WALL WHICH THEY SUPPORT. FLOOR BEAMS FB21B AND FB23B SHALL BE CENTERED BELOW THE BRICK FACADE WHICH THEY SUPPORT.

DEMARCATON	MINIMUM MOMENT CAPACITY	MINIMUM SHEAR CAPACITY	MINIMUM 'EI' x 1,000,000
FT21	14,015 FT*POUNDS	1,755 POUNDS	2,150.360
FT22	7,455 FT*POUNDS	1,230 POUNDS	1,075.180
FT23	4,725 FT*POUNDS	970 POUNDS	494.570
FT24	9,655 FT*POUNDS	1,410 POUNDS	1,530.880
FT25	20,730 FT*POUNDS	4,255 POUNDS	2,150.360
FT21	3,445 FT*POUNDS	1,150 POUNDS	207.750
FT22	4,985 FT*POUNDS	1,975 POUNDS	1,075.180
FT23	3,945 FT*POUNDS	1,175 POUNDS	225.060
FT24	425 FT*POUNDS	400 POUNDS	24.120

FLOOR TRUSS SCHEDULE
SCALE: NOT TO SCALE

FLOOR TRUSS SCHEDULE NOTES:

- WOOD FLOOR TRUSSES ARE SPECIFIED BY THE REQUIREMENTS OF THIS TABLE. THE WOOD TRUSS MANUFACTURER SHOULD VERIFY THESE TRUSS DESIGNS THROUGH THE USE OF THE DESIGN LOADS PROVIDED AS WELL AS THOSE THAT MAY BE CLARIFIED AT THE TIME OF MANUFACTURE.
- THE WOOD FLOOR TRUSSES SHALL BE DESIGNED TO SUPPORT THE CODE REQUIRED DESIGN LIVE LOADS AND DESIGN DEAD LOADS. WOOD FLOOR TRUSSES SHALL BE SUPPLIED THAT ARE COMPLIANT WITH ALL MINIMUM REQUIREMENTS INCLUDED WITHIN THESE CONTRACT DOCUMENTS.

DEMARCATON	SUPPORT MEMBER	BEARING STUD	FULL HEIGHT JAMB
WH21	(3) 2x6's	(1) 2x6	(1) 2x6
WH22	(3) 2x6's	(2) 2x6's	(2) 1 1/2"x8 1/2" LVL's
WH23	(3) 2x6's	(1) 2x6	(1) 1 1/2"x8 1/2" LVL
WH24	(3) 2x6's	(1) 2x6	(1) 1 1/2"x8 1/2" LVL's
WH25	(3) 2x8's	(1) 1 1/2"x8 1/2" LVL	(2) 1 1/2"x8 1/2" LVL's
WH26	(3) 1 1/2"x8 1/2" LVL's	(1) 1 1/2"x8 1/2" LVL	(1) 1 1/2"x8 1/2" LVL's
WH27	(3) 1 1/2"x14" LVL's	(1) 1 1/2"x8 1/2" LVL	(2) 1 1/2"x8 1/2" LVL's

WALL HEADER/JAMB/BEARING SCHEDULE
SCALE: NOT TO SCALE

WALL HEADER/JAMB/ BEARING STUD SCHEDULE NOTES:

- FULL HEIGHT JAMBS FROM WH25 AND WH27 SUPERCEDE THE REQUIREMENTS OF THE FULL HEIGHT JAMBS FOR WH24 AND WH26 WHERE THERE IS INSUFFICIENT ROOM FOR ALL FULL HEIGHT STUDS SPECIFIED.
- WHERE SIMPSON STRONG TIE STEEL STRONG-WALL DO NOT ALLOW THE SPECIFIED QUANTITY OF FULL HEIGHT WALL STUDS, ANY AREA AVAILABLE SHALL BE FILLED WITH FULL HEIGHT 2x6's AND SHALL BE ATTACHED TO THE SIMPSON STRONG TIE STEEL STRONG-WALL TO TRANSFER ALL LATERAL FORCES.

DRAWING SIB NOTES, THIRD LEVEL FRAMING PLAN

- SEE DRAWING SO.1 AND SO.2 FOR GENERAL NOTES.
- TYPICAL DETAILS APPLY TO ALL DRAWINGS. USE THROUGHOUT, EXCEPT WHERE OTHERWISE SHOWN OR NOTED.
- TOP OF METAL PLATE CONNECTED WOOD FLOOR TRUSSES VARY. TYPICAL TOP OF WOOD FLOOR TRUSSES (DEMARCATED AS FT2#) IS 120'-0", TOP OF WOOD FLOOR TRUSSES (DEMARCATED AS FT2#) IS 114'-5 1/2".
- FLOOR DECKING SHALL BE 3/4" APA RATED STRUCTURAL FLOOR SHEATHING (PLYWOOD) WITH SPAN RATING TO COMPLY WITH CODE-REQUIRED LOADS. ATTACH SHEATHING PER BUILDING CODE REQUIREMENTS.
- ALL DIMENSIONS MUST BE OBTAINED FROM ARCHITECTURAL DRAWINGS PRIOR TO PREPARING SHOP DRAWINGS. SEE GENERAL NOTES FOR ADDITIONAL EXAMPLES OF DIMENSIONS WHICH MUST BE COORDINATED/VERIFIED WITH OTHERS PRIOR TO PREPARING SHOP DRAWINGS.
- FD INDICATES SPAN OF FLOOR DECK
- DESIGN LOADS:
T1. LIVE LOAD, 40 PSF LIVE LOAD.
T2. DEAD LOAD*, TYPICAL (TRUSSES DEMARCATED FT2#), 30 PSF.
T3. DEAD LOAD, PATIO (TRUSSES DEMARCATED FT2#), 100 PSF.
T4. VERIFY DESIGN DEAD LOAD WITH ACUTAL FLOOR (AND PATIO) FINISHES SPECIFIED.
* THE DESIGN DEAD LOAD USED MAY BE REVISED ONCE AN ACoustical FLOOR/ CEILING SYSTEM AND FLOOR FINISHES HAVE BEEN DETERMINED. THE LICENSED ENGINEER FOR THE WOOD FLOOR TRUSS MANUFACTURER MAY (OR MAY BE REQUIRED TO) ADJUST THE DESIGN LOAD BASED UPON THE ACUTAL DEAD LOAD OF THE FLOOR. THE ARCHITECT SHALL BE NOTIFIED IMMEDIATELY IF THE ACTUAL DEAD LOAD EXCEEDS THAT WHICH HAS BEEN ASSUMED ABOVE.
- METAL PLATE CONNECTED WOOD TRUSS MANUFACTURER IS RESPONSIBLE TO PROVIDE TRUSSES CAPABLE OF SPANNING BETWEEN NOTED ALLOWABLE BEARING LOCATIONS.
- METAL PLATE CONNECTED WOOD TRUSSES ARE LOCATED AT A TYPICAL SPACING OF 1'-6" ON CENTER, NO GREATER. ALL WOOD TRUSSES SHALL BE BROUGHT TO BEAR ON A WALL STUD.
- METAL PLATE CONNECTED WOOD TRUSSES SUPPORTING WALLS (ET AL) SHALL BE PROVIDED OF SUFFICIENT WIDTH TO SUPPORT THE MATERIAL. FOR EXAMPLE FLOOR BEAMS FB21 AND FB23 HAVE BEEN SPECIFIED AS TWO PAIR OF TRIPLED UP LVL'S TO SUPPORT THE 9 1/2" WALL ABOVE AND THE 3 1/2" BRICK FACADE ABOVE.
- ALL BEARING STUDS SHALL REMAIN SOLID UNTIL BROUGHT TO BEAR ON THE BUILDING FOUNDATION OR A SUPPORTING MEMBER, BELOW.

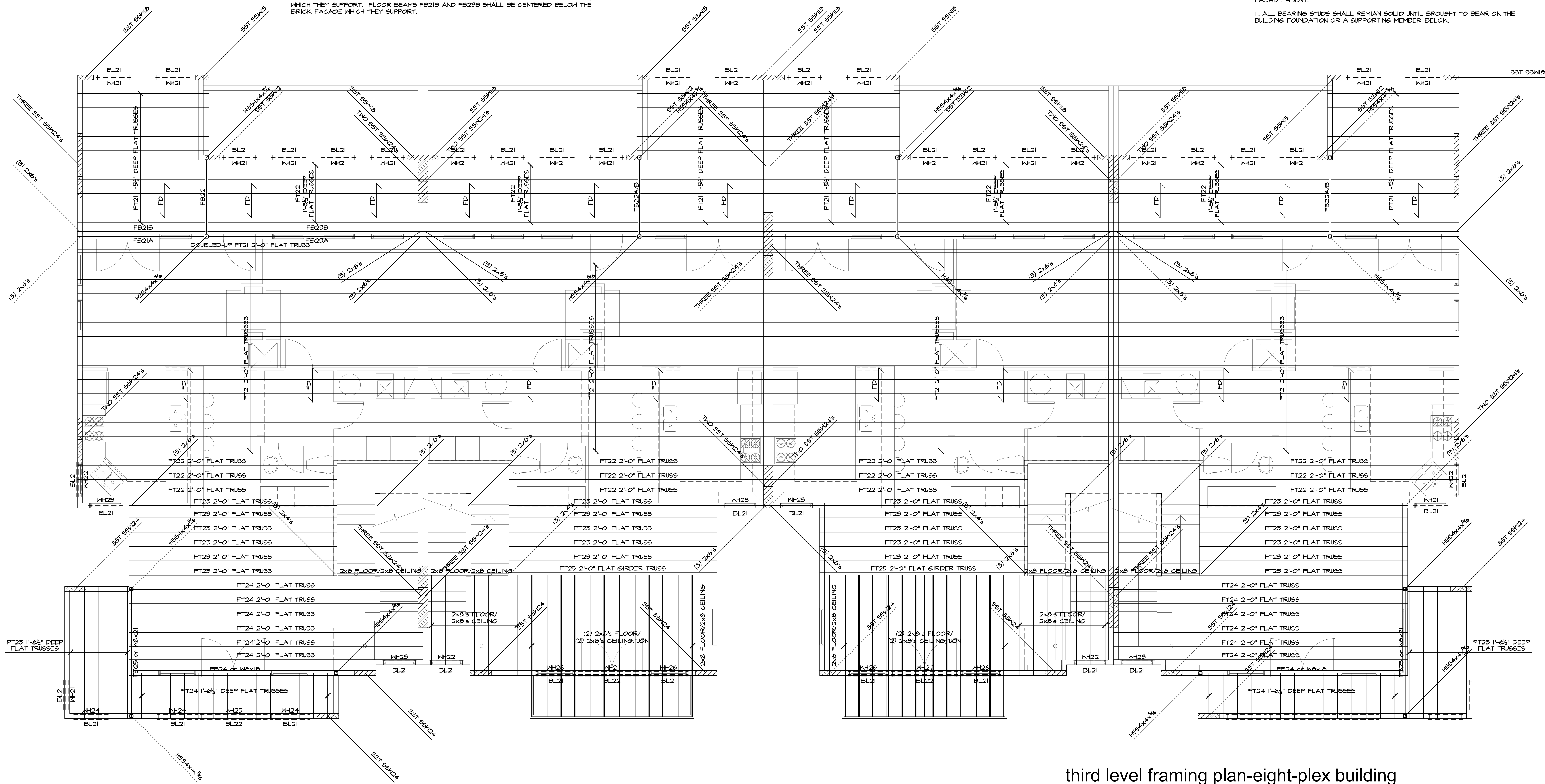

third level framing plan-eight-plex building
SCALE: 1/4"=1'-0"

Copyright 2004 - Preview Architecture + Planning, LLC
preview ARCHITECTURE + PLANNING, L.L.C.
 512 Madison Avenue - Rochester, Michigan 48307
 Ph. 248.652.4112 www.previewap.com
 michigan@previewap.com

PROJECT:
Mill Town Condominium Development
 Mill Street
 Rochester, Michigan

CLIENT:
Trident Rochester, LLC
 3400 East Lafayette
 Detroit, Michigan 48310
 586.987.8006

NO.	DESCRIPTION	DATE
1	Review	02.21.05

CONSULTANT:
AE STRUCTURES
 Architecturally Engineered Structures, PLLC
 Structural Engineering Consultants
 www.AEStructures.com
 1118 Joshua Drive
 Troy, Michigan 48068-6507
 Telephone / Facsimile: 248-628-0111
 AEStructures@AEStructures.com

SEAL:
Preliminary. Not for Construction

SHEET TITLE:
 PROJECT NUMBER:
 2003-131
 DRAWN BY:
 CHECKED BY:
 SHEET NUMBER:

S1.3